

# TWO-PLY JUMBOTEX<sup>®</sup>

WEATHER-RESISTIVE BARRIER

PREMIER

## Part of a Complete Moisture Control System

Two-Ply Jumbo Tex is a member of the Jumbo Tex family – a product line that has set the industry standard for effectiveness and durability as a weather-resistive barrier behind all major exterior wall claddings. It has been chosen by builders and architects to protect over *five million* homes and commercial buildings from the problems caused by water intrusion and excessive moisture.

“Provides the ideal balance between water protection and vapor permeability, to keep walls dry and homes comfortable...”

Two-Ply Jumbo Tex is engineered for production and custom residential construction applications that require a tough water and moisture barrier that offers outstanding water and moisture protection. It delivers over *ten times* the water resistance of regular Grade “D” building paper, while having the durability to endure rugged jobsite conditions. The product is part of a complete Moisture Control System for walls

engineered by the Fortifiber Building Systems Group<sup>®</sup>, which helps manage and eliminate moisture-related problems – including water-related structural failures, mold and mildew.

Two-Ply Jumbo Tex provides the ideal balance between water protection and vapor permeability, to keep walls dry and homes comfortable. The product also reduces air infiltration in exterior walls, contributing to energy savings.

Two-Ply Jumbo Tex is comprised of two layers of asphalt-saturated building paper, which is considered by many building science experts to provide the ideal drainage plane behind exterior claddings, and to increase the drying potential of the wall system when wet. Dual layers result in better sealing around attachment fasteners and better building envelope integration. Unlike some housewraps, it will retain its weather-resistive properties when exposed to either job site surfactants or wood extracts and tannin derivatives from wood siding.

## Unique Weather-Resistive Properties

The product’s pliability and 40 inch wide roll size make it easier to install and store on the jobsite than other weather-resistive building materials. It is also a very cost-effective solution, while providing solid protection against water intrusion and moisture problems. When the code requires two layers of Grade “D” building paper, Two-Ply Jumbo Tex does the job in one pass, saving costly labor dollars. In fact, it is possible to pay up to three times more for other weather-resistive barriers that cannot surpass its reliable performance behind stucco, fiber cement siding, brick, vinyl and wood siding.

## Decades of Proven Performance

Two-Ply Jumbo Tex is a product manufactured by the Fortifiber Building Systems Group. With more than a seventy-five year history of proven performance, technical expertise and practical know-how, the company has become a trusted partner to builders, architects and code officials.

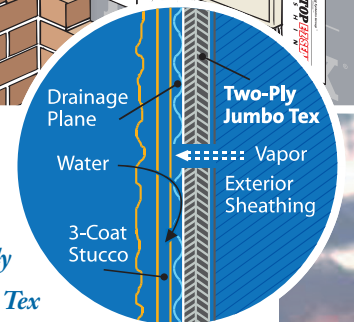
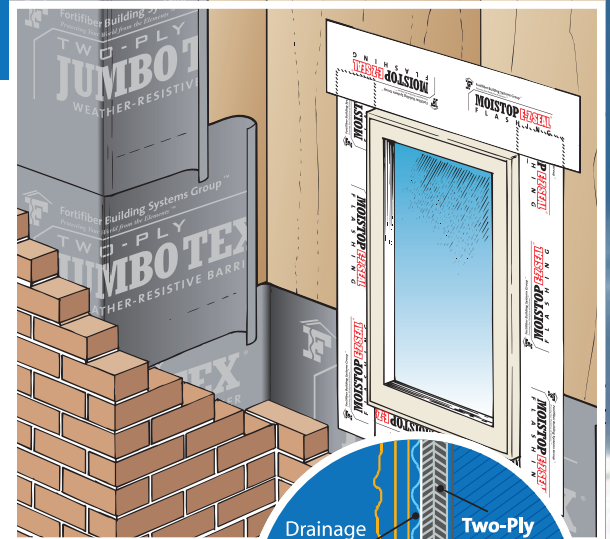

Two-Ply  
Jumbo Tex

protects against water intrusion from the outside, while allowing moisture to escape from the inside.

- SOLID PROTECTION AGAINST MOISTURE PROBLEMS
- EXCEPTIONAL WATER RESISTANCE
- SOLID PRICE-PERFORMANCE
- IDEAL BALANCE BETWEEN WATER RESISTANCE AND PERMEABILITY
- FOR STUCCO, FIBER CEMENT SIDING, BRICK, VINYL AND WOOD SIDING
- LABOR SAVINGS FOR TWO-PLY CODE REQUIREMENTS



## TWO-PLY JUMBO TEX

**Product Description:** Two-Ply Jumbo Tex is a premier grade weather-resistive barrier designed for use behind a variety of exterior wall claddings. It provides excellent protection from internal wall damage due to moisture leakage and condensation.

**Composition:** Two-Ply Jumbo Tex is an asphalt-saturated kraft Grade “D” breather type sheathing paper.

**Size & Weight:** Two-Ply Jumbo Tex is available in 40" x 162 sq. ft. and 40" x 250 sq. ft. rolls. Product weight is approximately 7.2 lbs/100 sq. ft.

**Applicable Standards:** Exceeds Federal Specification UU-B-790a, Type 1, Grade “D”, Style 2.

Complies with the International Code Council Evaluation Services Acceptance Criteria for Water Resistive Barriers (AC 38).

Complies with the Uniform Building Code Standard 14-1.

Complies as an alternative to the water-resistive barrier specified in Section 1404.2 of the International Building Code®.

Complies as an alternative to the weather-resistant sheathing papers specified in Section R703.2 of the International Residential Code®.

ICC Evaluation Service Report 1027.

American Society for Testing & Materials (ASTM):

- ASTM D-779 - Standard Test Method for Water Resistance of Paper, Paperboard and Other Sheet Materials by the Dry Indicator Test Method
- ASTM D-828 - Tensile Properties of Paper and Paperboard Using Constant-Rate-of-Elongation Apparatus
- ASTM E-96 - Water Vapor Transmission of Materials

**Physical Properties:** Two-Ply Jumbo Tex is continually tested in accordance with ASTM procedures. The values shown in Table 1 are typical values obtained in these tests.

**Limitations:** Product should be covered as soon as possible. Inspect product to insure it is free of any protrusions or damage which may detract from the weather-resistive barrier integrity. Holes, tears or punctures should be sealed with

Moistop® Sealant or Fortifiber Sheathing Tape. This product is not recommended for horizontal, below grade or roofing applications.

**Installation:** Two-Ply Jumbo Tex should be installed in accordance with the local applicable building code. The International Residential Code Section R703.2 and Uniform Building Code Standard 14-1, section 1402.1, state that weather-resistive barriers should be applied horizontally, with the upper layers overlapping the lower layer by a minimum of 2" (3" is recommended), and all vertical joints should be lapped a minimum of 6". To ensure the integrity of the weather-resistive barrier system, Fortifiber strongly recommends the use of a Two-Ply Jumbo Tex product or two layers of a single ply Jumbo Tex product when used with a three-coat stucco system. Do not tape horizontal or vertical seams.

**Availability:** The Fortifiber Building Systems Group's products are distributed nationwide. For product information and pricing, please call a Fortifiber distributor near you. If you need assistance locating a participating distributor, please call our Customer Service Department at 1-800-773-4777.

**Fortifiber Warranty:** This product may be eligible for Fortifiber's FortiShield 15 year warranty when used in conjunction with other Fortifiber products. Please see our website at [www.fortifiber.com/warranty.htm](http://www.fortifiber.com/warranty.htm) for details.

Fortifiber Corporation warrants that its products are in compliance with their published specifications and are free from defects in materials and workmanship for a period of two years from the date of purchase. This warranty does not apply to loss due to abuse. Material found to be defective will be replaced at no charge by Fortifiber, but in no event shall Fortifiber be liable for any other costs or damages, including any labor costs.

THIS EXPRESS WARRANTY IS GIVEN IN LIEU OF AND EXCLUDES ALL OTHER EXPRESS OR IMPLIED WARRANTIES, INCLUDING BUT NOT LIMITED TO THE IMPLIED WARRANTIES OF MERCHANTABILITY AND FITNESS FOR A PARTICULAR PURPOSE.

Fortifiber's sole obligations under this warranty are as set forth herein. In no event shall Fortifiber be liable for any lost revenue or profits, direct, indirect, special, incidental or consequential damages of any kind.

**SPECIFICATION SUMMARY:** Provides secondary weather protection behind exterior cladding to prevent moisture penetration and condensation in exterior wall assemblies.

**WEATHER-RESISTIVE BARRIER:** Fortifiber/Two-Ply Jumbo Tex asphalt saturated kraft Grade “D” breather type sheathing paper.

**REFERENCE SPECIFICATION:** Federal Specification UU-B-790a, Type 1, Grade “D”, Style 2.

*Table 1- Physical Properties*

CHARACTERISTIC	TEST METHOD	RESULTS	INDUSTRY STANDARD
Water Vapor Transmission	ASTM E-96 (A)	95 grams 14 perms (MVT)	35 grams (min.) 5 perms (MVT)
Water Resistance	ASTM D-779	110 minutes	10 minutes per ply
Tensile Strength	ASTM D-828	MD - 144 lb. <sup>f</sup> /inch CD - 58 lb. <sup>f</sup> /inch	MD - 20 lb. <sup>f</sup> /inch CD - 20 lb. <sup>f</sup> /inch



**Fortifiber Building Systems Group®**  
Protecting Your World from the Elements®

Call 1-800-773-4777 or 1-775-333-6400 for sales and technical assistance. On the Internet visit [www.fortifiber.com](http://www.fortifiber.com).

© 2014 Fortifiber Building Systems Group. Fortifiber®, FortiShield®, Jumbo Tex®, Moistop® Sealant and Protecting Your World from the Elements® are trademarks of Fortifiber Corporation. 5/16